

PJ1145 UPPER LIFFEY VALLEY SEWERAGE SCHEME UPGRADE WORKS - SCHEME LOCATION

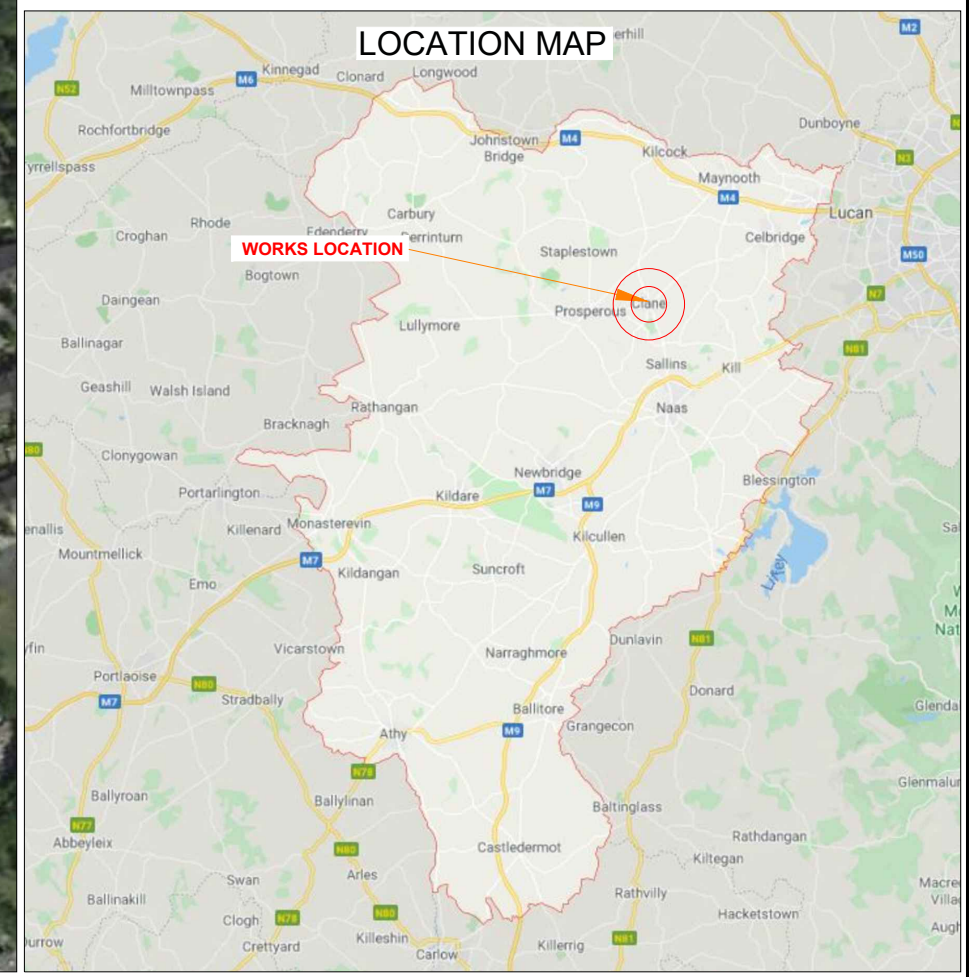
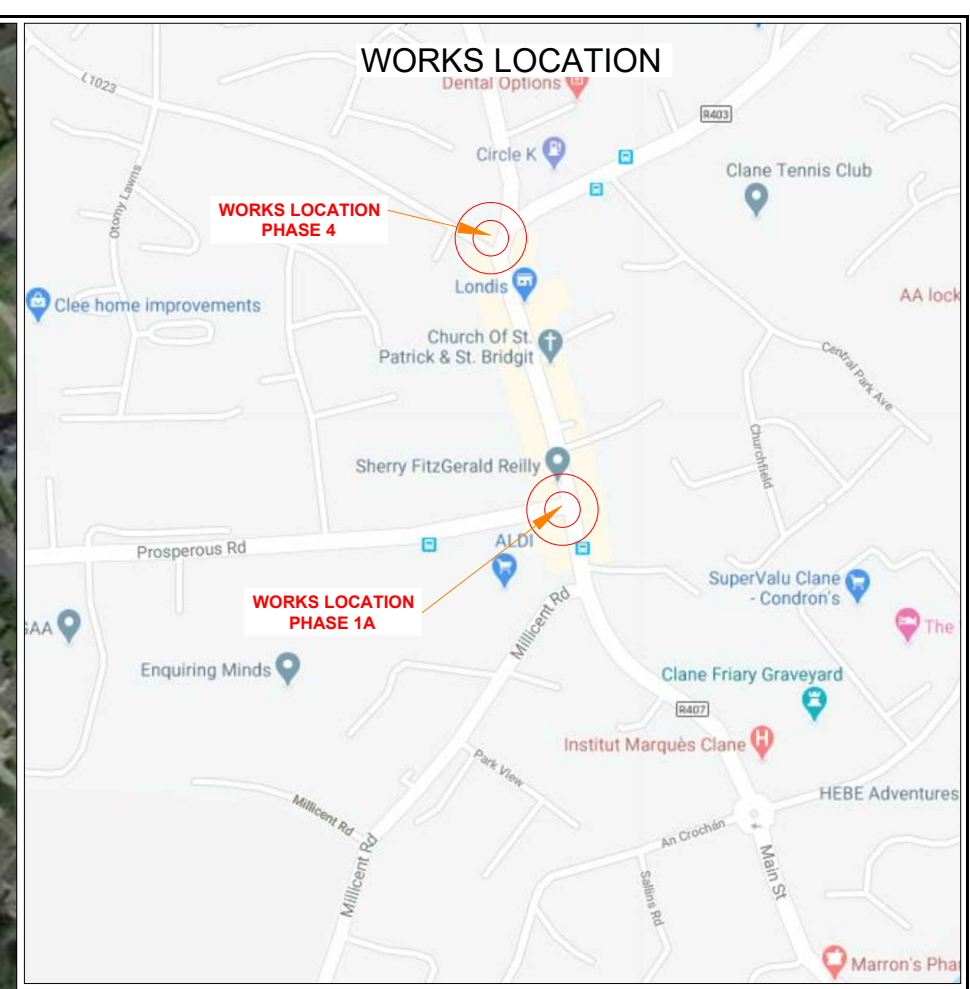

DESIGN PARAMETERS			
Speed Limit	50 km/h	Sign size (diamond)	600mm
Road Classification	1(iii)	Sign size (circular)	600mm
Roadworks type	A	Minimum Cone size	750mm
Number of advance signs	2	Cone spacing at tapers	3m
Sign visibility	50m	Cone spacing longitudinal	3m
Distance between signs	20m	Lateral Safety Zone	0.5m
Taper at lane	1 in 5	Longitudinal Safety Zone	5m
Taper at hard shoulder	N/A	Minimum lane width	3.00m

LEGEND	
	- Phase 1
	- Phase 1B

GENERAL NOTES

- All information contained in this drawing (including digital data) should be checked and verified prior to any stage of construction.
- All works are to be carried out in accordance with local authority requirements and are to be included in the site-specific safety & health plan.
- Site inspections and maintenance of the traffic management layout is to be agreed with local authority to ensure the safety and integrity of the design.
- Contractor to carry out a site risk assessment prior to the installation of any traffic management plan to ensure that conditions reflect those considered for design post submission.
- Contractor shall be responsible for the provision of ramp access at any change in road surface level where traffic runs on a temporary surface, and for pedestrian/cycle ramps where footpath/cycle-ways have a level discontinuity as per result of the works.

Rev	Date	Details	Dm	Chk	App	Dm	DS
							CS
							DH
							07-04-2020
							A1 NTS
							A3 NTS
							CONSTRUCTION

Project		J1145 UPPER LIFFEY VALLEY SEWERAGE SCHEME UPGRADE WORKS	
Title		TRAFFIC MANAGEMENT PLAN WORKS LOCATION	
Drawing No	C20001_03_016	Rev	0

PJ1145 UPPER LIFFEY VALLEY SEWERAGE SCHEME UPGRADE WORKS
DIVERSION ROUTE

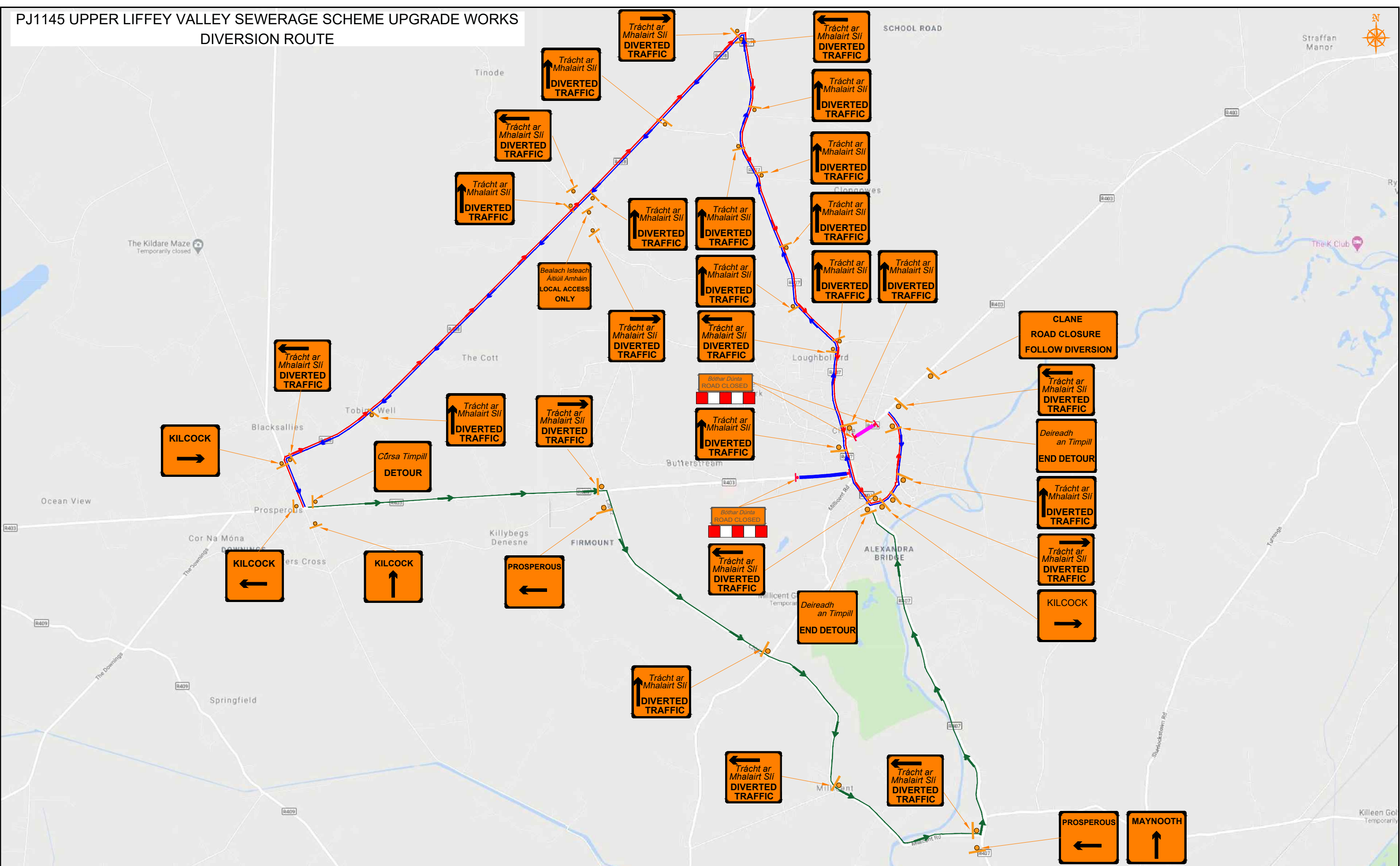

ROAD CONTROL

Copyright Notes:
This drawing is the property of Road Control Services Ltd. The design information contained herein is strictly confidential. This document is not to be used, reproduced, disclosed or circulated in whole or in part without prior written consent.

CLIENT

DESIGN PARAMETERS

Speed Limit	50 km/h	Sign size (diamond)	600mm
Road Classification	1(iii)	Sign size (circular)	600mm
Roadworks type	A	Minimum Cone size	750mm
Number of advance signs	2	Cone spacing at tapers	3m
Sign visibility	50m	Cone spacing longitudinal	3m
Distance between signs	20m	Lateral Safety Zone	0.5m
Taper at lane	1 in 5	Longitudinal Safety Zone	5m
Taper at hard shoulder	N/A	Minimum lane width	3.00m

LEGEND

- Traffic sign

GENERAL NOTES

- 1) All information contained in this drawing (including digital data) should be checked and verified prior to any stage of construction.
- 2) All works are to be carried out in accordance with local authority requirements and are to be included in the site-specific safety & health plan.
- 3) Site inspections and maintenance of the traffic management layout is to be agreed with local authority to ensure the safety and integrity of the design.
- 4) Contractor to carry out a site risk assessment prior to the installation of any traffic management plan to ensure that conditions reflect those considered for design post submission.
- 5) Contractor shall be responsible for the provision of ramp access at any change in road surface level where traffic runs on a temporary surface, and for pedestrian/cycle ramps where footpath/cycle-ways have a level discontinuity as per result of the works.

Rev	Date	Details	Dm	Chk	App	Dm	DS
						Chk	CS
						App	DH
						Date	07-04-2020
						Scale	A1 NTS A3 NTS
						Stage	CONSTRUCTION

Project **J1145 UPPER LIFFEY VALLEY SEWERAGE SCHEME UPGRADE WORKS**

Title **TRAFFIC MANAGEMENT PLAN DIVERSION ROUTE**

Drawing No **C20001_03_018** Rev **0**

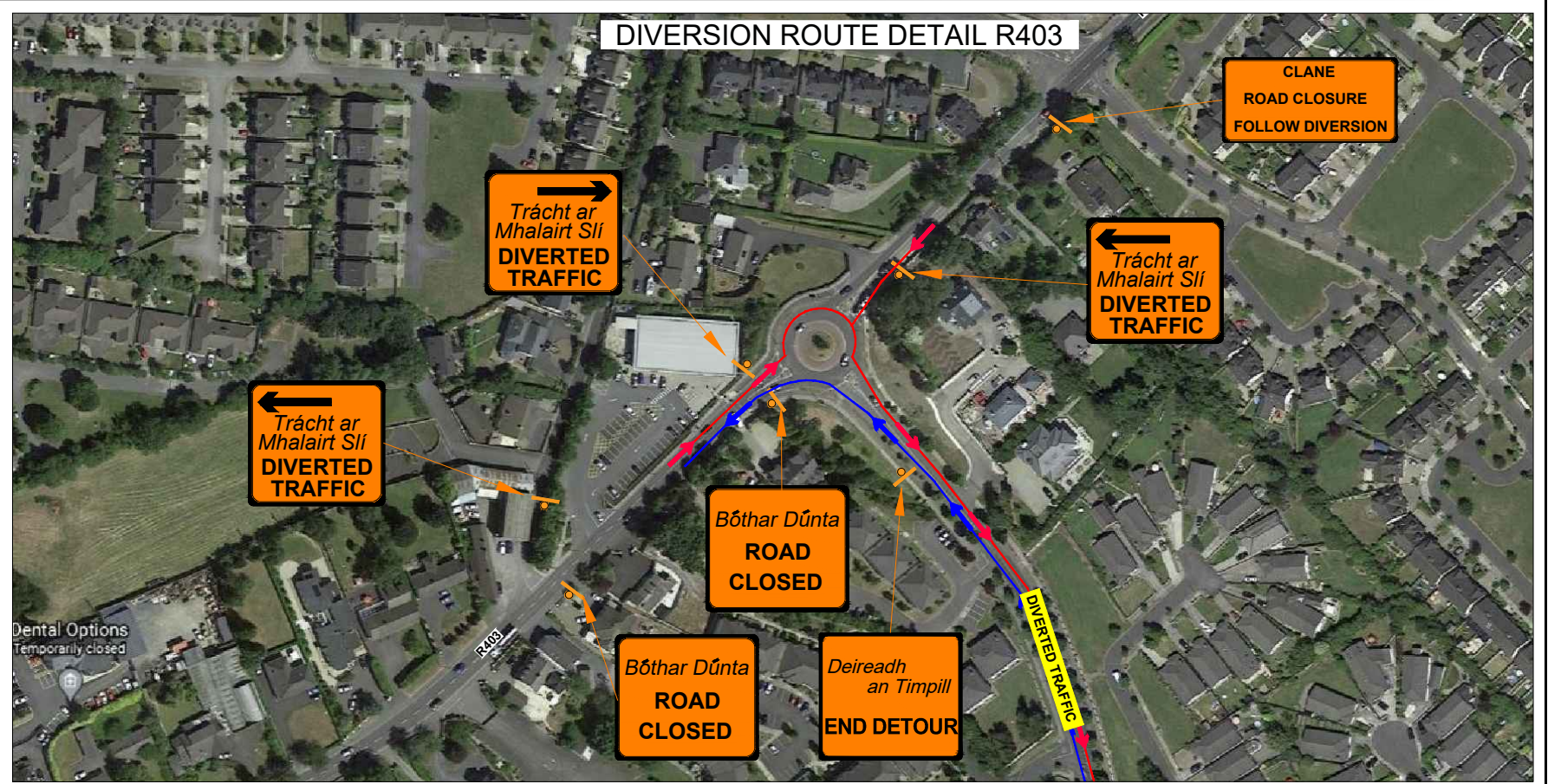
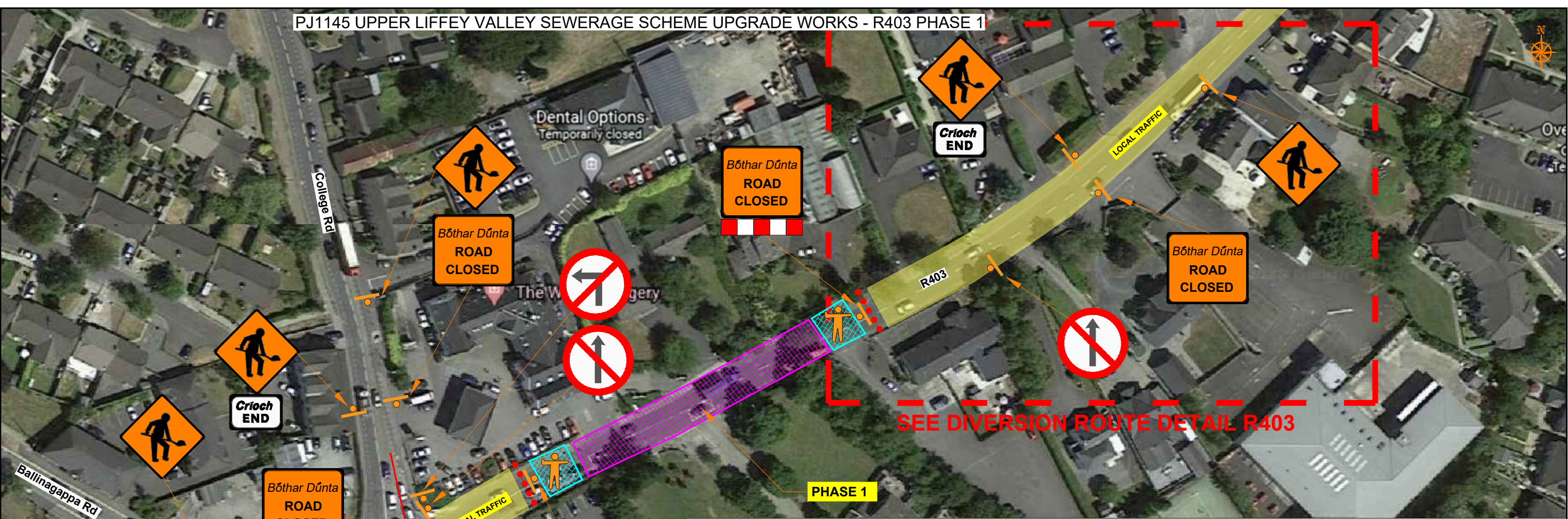

ROAD CONTROL

Copyright Notes: This drawing is the property of Road Control Services Ltd. The design information contained herein is strictly confidential. This document is not to be used, reproduced, disclosed or circulated in whole or in part without prior written consent.

CLIENT

DESIGN PARAMETERS

Speed Limit	50 km/h	Sign size (diamond)	600mm
Road Classification	1(iii)	Sign size (circular)	600mm
Roadworks type	A	Minimum Cone size	750mm
Number of advance signs	2	Cone spacing at tapers	3m
Sign visibility	50m	Cone spacing longitudinal	3m
Distance between signs	20m	Lateral Safety Zone	0.5m
Taper at lane	1 in 5	Longitudinal Safety Zone	5m
Taper at hard shoulder	N/A	Minimum lane width	3.00m

LEGEND

- Works Area
- Long. Safety Zone
- Traffic sign
- Traffic cones
- South Diversion
- TM Marshall

GENERAL NOTES

- All information contained in this drawing (including digital data) should be checked and verified prior to any stage of construction.
- All works are to be carried out in accordance with local authority requirements and are to be included in the site-specific safety & health plan.
- Site inspections and maintenance of the traffic management layout is to be agreed with local authority to ensure the safety and integrity of the design.
- Contractor to carry out a site risk assessment prior to the installation of any traffic management plan to ensure that conditions reflect those considered for design post submission.
- Contractor shall be responsible for the provision of ramp access at any change in road surface level where traffic runs on a temporary surface, and for pedestrian/cycle ramps where footpath/cycle-ways have a level discontinuity as per result of the works.

Rev	Date	Details	Dm	Chk	App	Dm	DS

Project **J1145 UPPER LIFFEY VALLEY SEWERAGE SCHEME UPGRADE WORKS**

Title **TRAFFIC MANAGEMENT PLAN R403 - PHASE 1**

Date **07-04-2020**

Scale **A1 NTS**
A3 NTS

Stage **CONSTRUCTION**

Drawing No **C20001_03_017** Rev **0**